



The Chace Mill
One Mill Street
Burlington, VT 05401



Carefree, Secure, Rewarding

Making independent living easy.



*Your Independent
Living Community*

Northern Meridian is the independent living community designed with your active lifestyle in mind. Our residents are right where they want to be — in a beautiful, maintenance-free home that makes it easy to pursue the important things in life! This is the living environment that allows you to do the things you've always wanted.

Never retire your spirit

The community of Northern Meridian is enhanced by the common areas where social activities can be held, an indoor pool for your physical health and an indoor greenhouse for the green-thumbed hobbieist. All of the households are garden apartments, smartly designed with two bedrooms and two full baths, a fully-equipped kitchen and even laundry hook-ups. This layout makes it easy for family or even long-term visitors to share your home.

A location to make life easy

Northern Meridian is centrally located in South Burlington with easy access to downtown Burlington, I-89 and just two miles from the largest mall in Vermont.



Close to the airport for your Lock-&-Go lifestyle!



*Independent living at its best!
Indoor pool and greenhouse, beautiful mountain views
and the convenience of your amenities included in the rent!*

You are invited!

Northern Meridian is now accepting reservations. We look forward to showing you how independent living can make you feel carefree, secure and enriched!

Features

- ✿ Single level garden apartments
- ✿ Elevator access
- ✿ All basic amenities included in one monthly fee
- ✿ Outdoor balcony for every residence
- ✿ Two spacious bedrooms and two baths
- ✿ Indoor pool and greenhouse
- ✿ Underground parking
- ✿ Laundry hookups in each unit
- ✿ Common rooms
- ✿ Beautiful mountain views
- ✿ Bring your pet
- ✿ Just Lock-&-Go!
- ✿ Programs for active lives

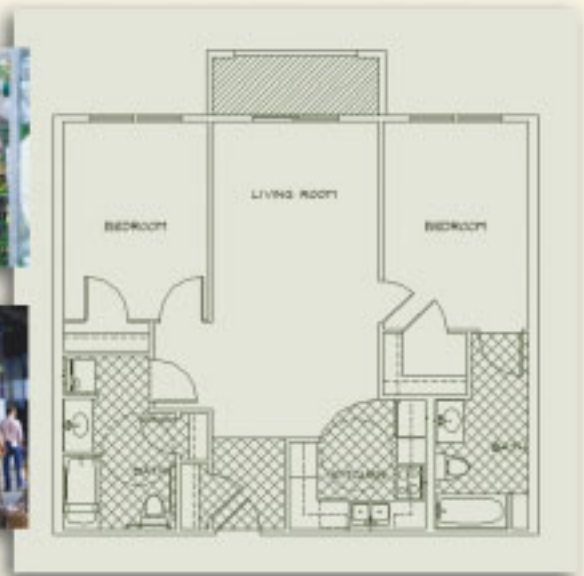

*Your
Independent
Living
Community*

Contact Information:

Kathy Levins
Neville Companies
802-862-0208
Email: kathy@nevilleco.com
www.nevilleco.com

